



**Accessories catalog**

# Eco Plus



## Cup

## Head body

## Filter Bag

0150

0156

0708



Steel-aluminium head cup Eco Plus.

Body that connects abrasive with air (abrasive nozzle with air nozzle).

Linen filter for Eco Plus.

**Abrasive nozzle - boron carbide**

5621



Abrasive nozzle boron carbide, diameter 5 mm. Located in engraving head.

**Abrasive nozzle – tempered**

5019



Abrasive nozzle – tempered, diameter 5 mm, located in engraving head.

**Abrasive nozzle – sintered carbide**

5086



Abrasive nozzle – sintered carbide, diameter 5 mm, located in engraving head.

**Air nozzle – tempered**

0171



Air nozzle which supplies air to engraving head.

**Suction hose**

0123



Air suction hose which supplies air together with abrasive from the sandblasting head to the sandblasting machine's tank.

**One-row brush**

0178



One-row brush with short, black hairs for Eco-Plus.

**Three-row brush**

2032



Three-row brush with long, white hairs for Eco-Plus.

**3/8 inch G filter pressure regulator**

0511



The valve which controls pressure at the outlet and purifies compressed air. It is fitted with a dehydrator and a gauge.

**Suction tube**

0153



The tube which sucks in abrasive from the tank.

**Air suction hose socket**

0704



Air suction hose socket which is situated on the tank of the sandblasting machine. It is connected with the suction hose connector.

**Complete engraving head**

0198



Complete engraving head for Eco-Plus.

**36' silicon carbide**

0084



36' silicon carbide for injector sandblasting machines. Bag: 25 kg.

### Suction hose connector (front)

0706



The connector which connects the suction hose with the sandblasting head.

### Suction hose connector (back)

0707



The connector which connects the suction hose with the tank.

### Abrasive stub-pipe

0115



The stub-pipe which fastens abrasive hose to the head body.

### Connector

0619



The connector which connects air valve with the head body.

### 1200W suction motor

1018



air suction motor situated in the head of the vacuum.

# Sandmaster Junior

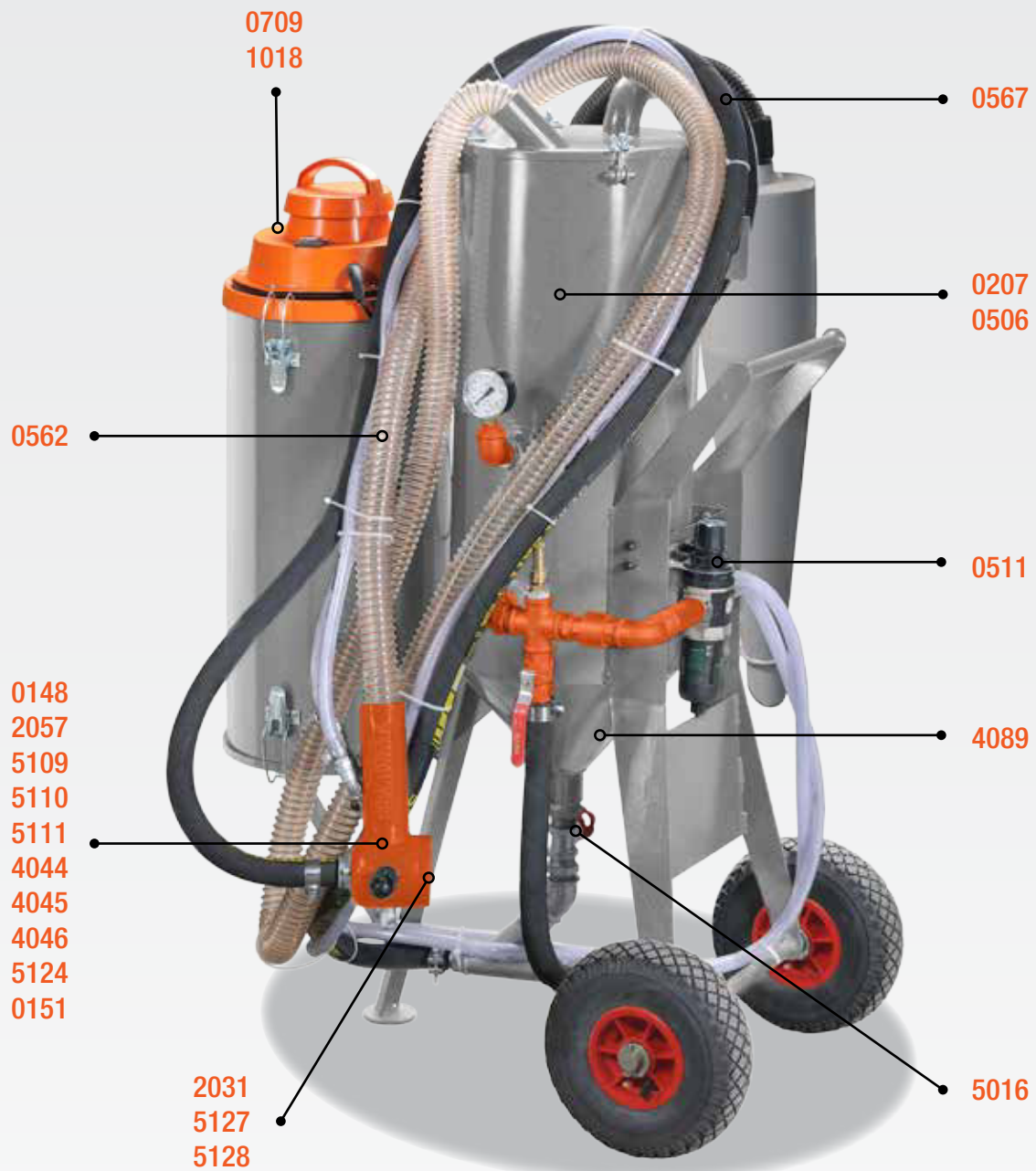

## Head (cast)

2057



Sandblasting head for Sandblaster Junior and Junior Plus sandblasting machines (cast).

## Complete head

0148



Complete sandblasting head for Sandblaster Junior and Junior Plus sandblasting machines (cast+fittings).

## Linen filter (old types)

0207



Linen filter for old types of sandblasting machines.

### Linen filter (new types)

0506



Linen filter for new types of sandblasting machines.

### 1200W suction motor

1018



Air suction motor situated in the head of the vacuum.

### Head cover (rubber)

5124



Sandblasting head cover (rubber, 80 mm long).

### Nozzle frame

0151



Sandblasting nozzle frame situated in the sandblasting head.

### Abrasive rubber hose

0567



Rubber hose which supplies abrasive to sandblasting head.

### Air suction hose

0562



The hose which pipes air together with abrasive from the sandblasting head to the tank.

### 3/8 inch G filter pressure regulator

0511



The valve which controls pressure at the outlet and purifies compressed air. It is fitted with a dehydrator and a gauge.

### Abrasive nozzle – sintered carbide 3mm

5109



Abrasive nozzle – sintered carbide, internal diameter 3mm.

### Abrasive nozzle – sintered carbide 4mm

5110



Abrasive nozzle – sintered carbide, internal diameter 4mm.

### Abrasive nozzle – sintered carbide 5mm

5111



Abrasive nozzle – sintered carbide, internal diameter 5mm.

### Abrasive nozzle – boron carbide 3mm

4044



Abrasive nozzle – boron carbide, internal diameter 3mm.

### Abrasive nozzle – boron carbide 4mm

4045



Abrasive nozzle – boron carbide, internal diameter 4mm.

**Abrasive nozzle – boron carbide  
5mm**

4046



Abrasive nozzle – boron carbide, internal diameter 5mm.

**40' brown fused alumina**

0035



40' brown fused alumina, for sandblasting in stone or for blasting metal structures. Bag: 25 kg.

**Membrane valve (manual)**

5016



Membrane valve which controls abrasive flow.

**Two-row brush - short hair**

5127



Two-row brush - short hair.

**Three-row brush - short hair**

5128



Three-row brush - short hair.

**Three-row brush - long hair**

2031



Three-row brush - long hair.

**Nozzle frame sleeve**

0214



Connects nozzle frame with the head.

**Boron carbide nozzle frame**

4020



Boron carbide nozzle frame.

**Vacuum head (small)**

0709



Vacuum head, small, with motor.

**Mushroom valve**

4089



The valve which opens the flow of the abrasive from the pressure tank.

# Sandmaster Junior Plus

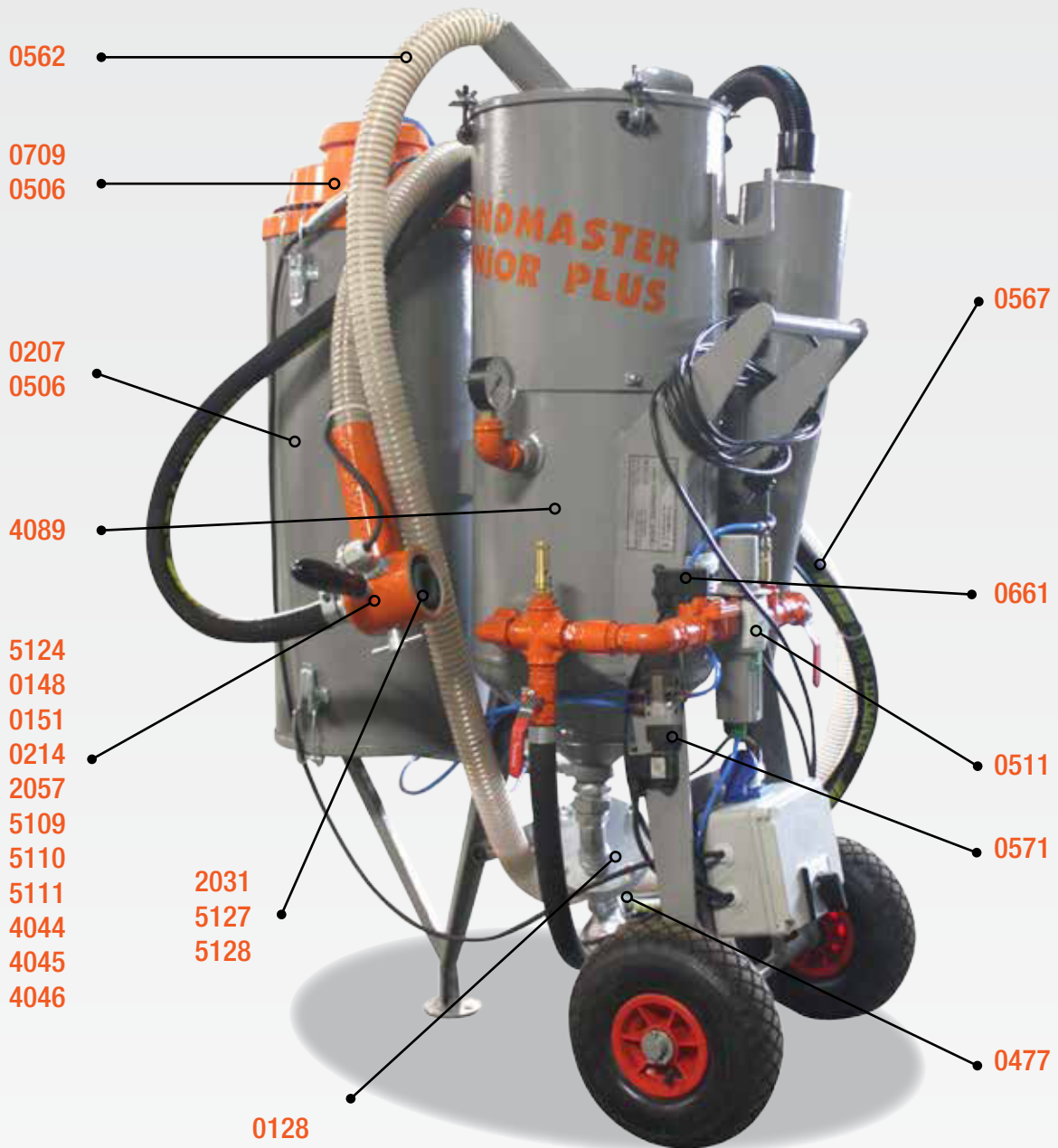

## Head (cast)

2057



Sandblasting head for Sandblaster Junior and Junior Plus sandblasting machines (cast).

## Complete head

0148



Complete sandblasting head for Sandblaster Junior and Junior Plus sandblasting machines (cast+fittings).

## Linen filter (old types)

0207



Linen filter for old types of sandblasting machines.



### Linen filter (new types)

0506



Linen filter for new types of sandblasting machines.

### 1200W suction motor

1018



Air suction motor situated in the head of the vacuum.

### Head cover (rubber)

5124



Sandblasting head cover (rubber, 80 mm long).

### Nozzle frame

0151



Sandblasting nozzle frame situated in the sandblasting head.

### Abrasive rubber hose

0567



Rubber hose which supplies abrasive to sandblasting head.

### Air suction hose

0562



The hose which pipes air together with abrasive from the sandblasting head to the tank.

### 3/8 inch G filter pressure regulator

0511



The valve which controls pressure at the outlet and purifies compressed air. It is fitted with a dehydrator and a gauge.

### 3/4 inch electrovalve

0661



The valve which controls airflow in the circuit.

### Electrovalve actuator

0571



The valve which controls the actuator's work.

### Abrasive nozzle – sintered carbide 3mm

5109



Abrasive nozzle – sintered carbide, internal diameter 3mm.

### Abrasive nozzle – sintered carbide 4mm

5110



Abrasive nozzle – sintered carbide, internal diameter 4mm.

### Abrasive nozzle – sintered carbide 4mm

5111



Abrasive nozzle – sintered carbide, internal diameter 5mm.

**Abrasive nozzle – boron carbide  
3mm**

4044



Abrasive nozzle – boron carbide, internal diameter 3mm.

**Abrasive nozzle – boron carbide  
4mm**

4045



Abrasive nozzle – boron carbide, internal diameter 4mm .

**Abrasive nozzle – boron carbide  
5mm**

4046



Abrasive nozzle – boron carbide, internal diameter 5mm .

**Two-row brush - short hair**

5127



Two-row brush - short hair.

**Three-row brush - short hair**

5128



Three-row brush - short hair.

**Three-row brush - long hair**

2031



Three-row brush - long hair.

**FSV disk valve**

0128



Disk valve which controls the flow of abrasive from the tank.

**D2 actuator**

0477



It controls the work of the disk valve.

**40' brown fused alumina**

0035



40' brown fused alumina, for sandblasting in stone or for blasting metal structures. Bag: 25 kg.

**Nozzle frame sleeve**

0214



Connects nozzle frame with the head.

**Mushroom valve**

4089



The valve which opens the flow of the abrasive from the pressure tank.

**Vacuum head (small)**

0709



Vacuum head, small, with motor.

**Air filter cartridge Junior Plus**

2050



Air filter cartridge Junior Plus.

**Boron carbide nozzle frame**

4020



Boron carbide nozzle frame.

# Sandmaster Plus

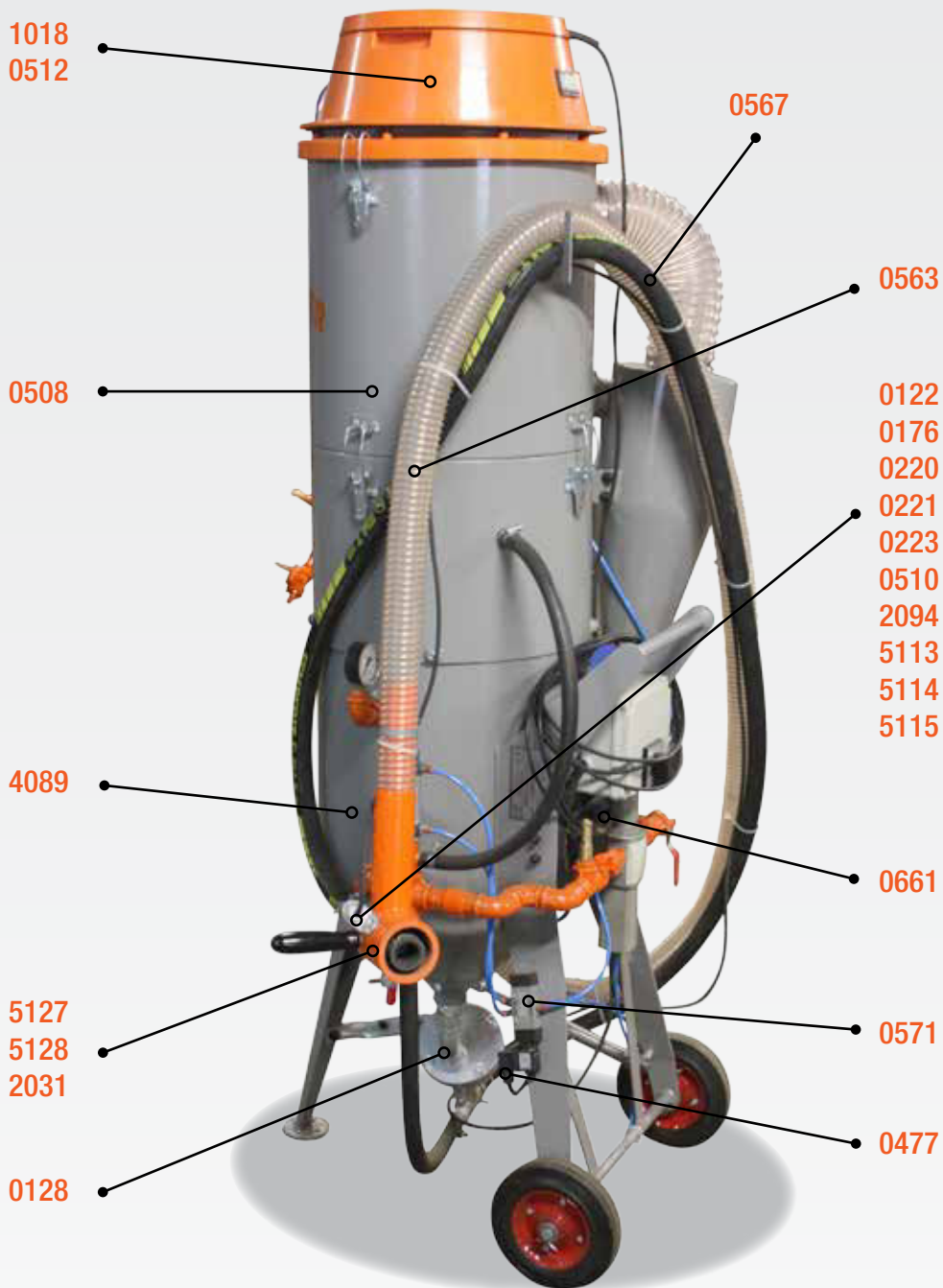

**Head (cast)**

2094



Sandblasting head for Sandmaster Plus and Sandmaster Pro sandblasting machines (aluminium cast).

**Complete head**

0122



Complete sandblasting head for Sandmaster Plus and Sandmaster Pro sandblasting machines (aluminium cast).

**Air filter cartridge**

0508



Filter for Sandmaster Plus sandblasting machine.

### 1200W suction motor

1018



Air suction motor situated in the head of the vacuum.

### Head cover (rubber)

5125



Sandblasting head cover (rubber, 110 mm long).

### Nozzle frame

0220



S andblasting nozzle frame situated in the sandblasting head.

### Nozzle fastening

0221



It connects the nozzle frame with the head, it holds the nozzle frame.

### Abrasive rubber hose

0567



Rubber hose which supplies abrasive to sandblasting head.

### Air suction hose

0562



The hose which pipes air together with abrasive from the sandblasting head to the tank.

### 1/2 inch G filter pressure regulator

0510



The valve which controls pressure at the outlet and purifies compressed air. It is fitted with a dehydrator and a gauge.

### 3/4 inch electrovalve

0661



The valve which controls airflow in the circuit.

### Electrovalve actuator

0571



The valve which controls the actuator's work.

### FSV disk valve

0128



Disk valve which controls the flow of abrasive from the tank.

### Short nozzle

0223



Nozzle that forms air stream.

### Abrasive nozzle – boron carbide 4mm

5113



Abrasive nozzle – boron carbide 4mm.

**Abrasive nozzle – boron carbide  
5mm**

5114



Abrasive nozzle – boron carbide 5mm.

**Abrasive nozzle – boron carbide  
6mm**

5115



Abrasive nozzle – boron carbide 6mm.

**Two-row brush - short hair**

5127



Two-row brush - short hair.

**Three-row brush - short hair**

5128



Three-row brush - short hair.

**Three-row brush - long hair**

2031



Three-row brush - long hair.

**Zawór grzybkowy**

4089



Zawór otwierający przepływ ścierniwa ze zbiornika ciśnieniowego.

**Vacuum head (large)**

0512



Vacuum head with two motors.

**40' brown fused alumina**

0035



40' brown fused alumina, for sandblasting in stone or for blasting metal structures. Bag: 25 kg.

**D2 actuator**

0477



It controls the work of the disk valve.

# Sandmaster Pro



## Head (cast)

2094



Sandblasting head for Sandmaster Plus and Sandmaster Pro sandblasting machines (aluminium cast).

## Complete head

0122



complete sandblasting head for Sandmaster Plus and Sandmaster Pro sandblasting machines (aluminium cast).

## Air filter cartridge

0509



filter for Sandmaster Pro sandblasting machine.

### 1200W suction motor

1018



Air suction motor situated in the head of the vacuum.

### Head cover (rubber)

5125



Sandblasting head cover (rubber, 110 mm long).

### Nozzle frame

0220



Sandblasting nozzle frame situated in the sandblasting head.

### Nozzle fastening

0221



It connects the nozzle frame with the head, it holds the nozzle frame.

### Abrasive rubber hose

0567



Rubber hose which supplies abrasive to sandblasting head.

### Air suction hose

0562



The hose which pipes air together with abrasive from the sandblasting head to the tank.

### Air suction hose

0563



The hose which pipes air together with abrasive from the sandblasting head to the tank.

### 1/2 inch G filter pressure regulator

0510



The valve which controls pressure at the outlet and purifies compressed air. It is fitted with a dehydrator and a gauge.

### 3/4 inch electrovalve

0661



The valve which controls airflow in the circuit.

### Electrovalve actuator

0571



The valve which controls the actuator's work.

### FSV disk valve

0128



Disk valve which controls the flow of abrasive from the tank.

### Short nozzle

0223



Nozzle that forms air stream.



**Abrasive nozzle – boron carbide  
4mm**

5113



Abrasive nozzle – boron carbide 4mm.

**Abrasive nozzle – boron carbide  
5mm**

5114



Abrasive nozzle – boron carbide 5mm.

**Abrasive nozzle – boron carbide  
6mm**

5115



Abrasive nozzle – boron carbide 6mm.

**Two-row brush - short hair**

5127



Two-row brush - short hair.

**Three-row brush - short hair**

5128



Three-row brush - short hair.

**Three-row brush - long hair**

2031



Three-row brush - long hair.

**Vacuum head (large)**

0512



Vacuum head with two motors.

**D2 actuator**

0477



It controls the work of the disk valve.

**40' brown fused alumina**

0035



40' brown fused alumina, for sandblasting in stone or for blasting metal structures. Bag: 25 kg.

# Cabin sandblasting machine (injector)



**Head body**

0156



Body that connects abrasive with air (abrasive nozzle with air nozzle).

**Filter Bag**

0708



Linen filter for Eco Plus.

**1200W suction motor**

1018



Air suction motor situated in the head of the vacuum.

**Abrasive nozzle – tempered**

5019



Abrasive nozzle – tempered, diameter 5 mm, located in engraving head.

**Air nozzle – tempered**

0171



Air nozzle which supplies air to engraving head.

**Protective gloves**

4005



They protect operator's hands against abrasive.

**3/8 inch G filter pressure regulator**

0511



The valve which controls pressure at the outlet and purifies compressed air. It is fitted with a dehydrator and a gauge.

**Suction hose**

0123



Air suction hose which supplies air together with abrasive from the sandblasting head to the sandblasting machine's tank.

**Industrial vacuum 1 motor**

0534



Vacuum for abrasive suction.

**Industrial vacuum 2 motors**

0049



Vacuum for abrasive suction.

**Suction tube**

0153



The tube which sucks in abrasive from the tank.

**Abrasive stub-pipe**

0115



The stub-pipe which fastens abrasive hose to the head body.

**Connector**

0619



The connector which connects air valve with the head body.

# Cabin sandblasting machine (pressure)



**Filter Bag**

0708



Linen filter for Eco Plus.

**1200W suction motor**

1018



Air suction motor situated in the head of the vacuum.

**Protective gloves**

4005



They protect operator's hands against abrasive.

**Industrial vacuum 2 motors**

0049



Vacuum for abrasive suction.

**Short nozzle**

0223



Nozzle that forms air stream.

**Nozzle frame**

0220



Sandblasting nozzle frame situated in the sandblasting head.

**3/8 inch G filter pressure regulator**

0511



The valve which controls pressure at the outlet and purifies compressed air. It is fitted with a dehydrator and a gauge.

**Suction hose**

0123



Air suction hose which supplies air together with abrasive from the sandblasting head to the sandblasting machine's tank.

**Industrial vacuum 1 motor**

0534



Vacuum for abrasive suction.

**Abrasive nozzle – sintered carbide  
3mm**

5109



Abrasive nozzle – sintered carbide, internal diameter 3mm.

**Abrasive nozzle – sintered carbide  
4mm**

5110



Abrasive nozzle – sintered carbide, internal diameter 4mm.

**Abrasive nozzle – sintered carbide  
4mm**

5111



Abrasive nozzle – sintered carbide, internal diameter 5mm.

**Abrasive nozzle – boron carbide  
3mm**

4044



Abrasive nozzle – boron carbide, internal diameter 3mm.

**Abrasive nozzle – boron carbide  
4mm**

4045



Abrasive nozzle – boron carbide, internal diameter 4mm .

**Abrasive nozzle – boron carbide  
5mm**

4046



Abrasive nozzle – boron carbide, internal diameter 5mm .

**Abrasive nozzle – boron carbide  
4mm**

5113



Abrasive nozzle – boron carbide 4mm.

**Abrasive nozzle – boron carbide  
5mm**

5114



Abrasive nozzle – boron carbide 5mm.

**Abrasive nozzle – boron carbide  
6mm**

5115



Abrasive nozzle – boron carbide 6mm.

**Nozzle frame**

0151



Sandblasting nozzle frame situated in the sandblasting head.

**Nozzle frame made of borcarbide**

4020



Nozzle frame made of borcarbide.

# Automatic tables for sandblasting

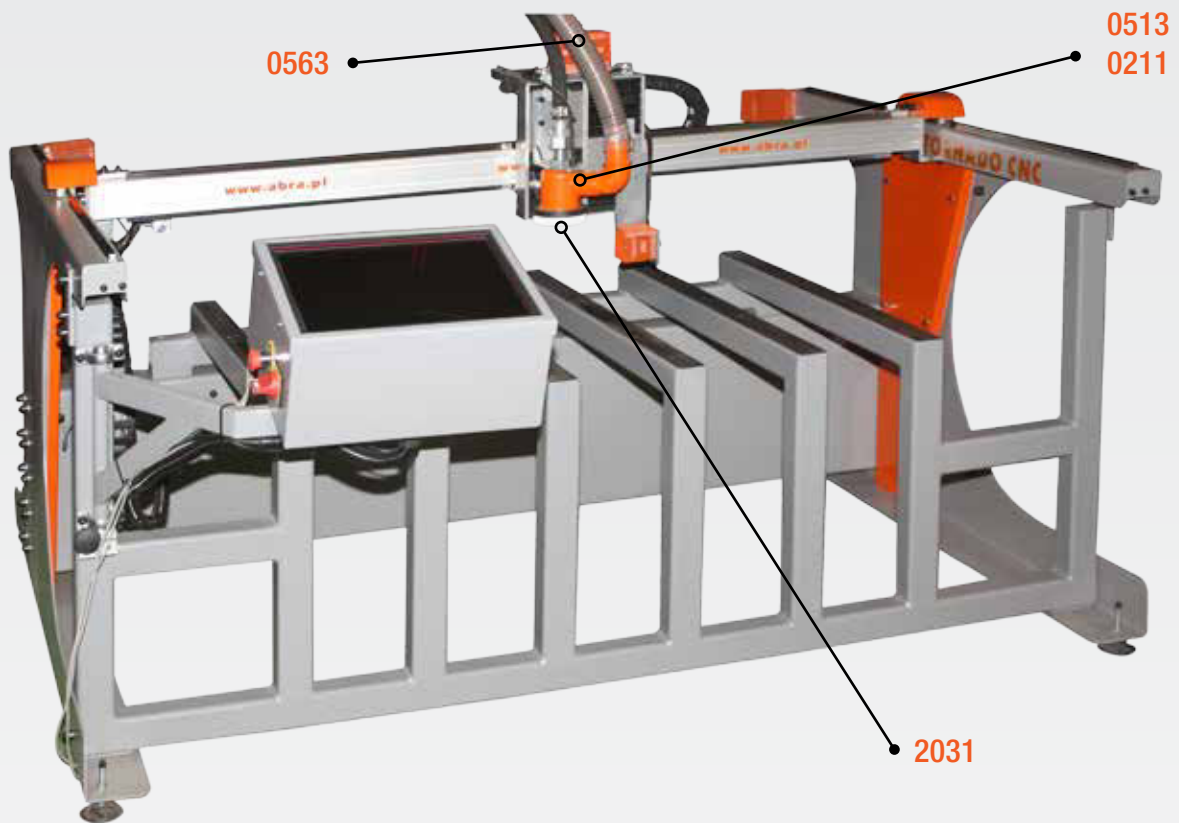

**Head (casting)**

0513



Sandblasting head for sandblasting table (aluminium casting).

**Complete head**

0211



Complete sandblasting head for sandblasting table (aluminium casting) - aluminium casting + fittings.

**Air suction hose**

0563



The hose which pipes air together with abrasive from the sandblasting head to the tank.

**Abrasive rubber hose**

0567



Rubber hose which supplies abrasive to sandblasting head.

**Three-row brush - long hair**

2031



Three-row brush - long hair.

# Sandmaster Mobile

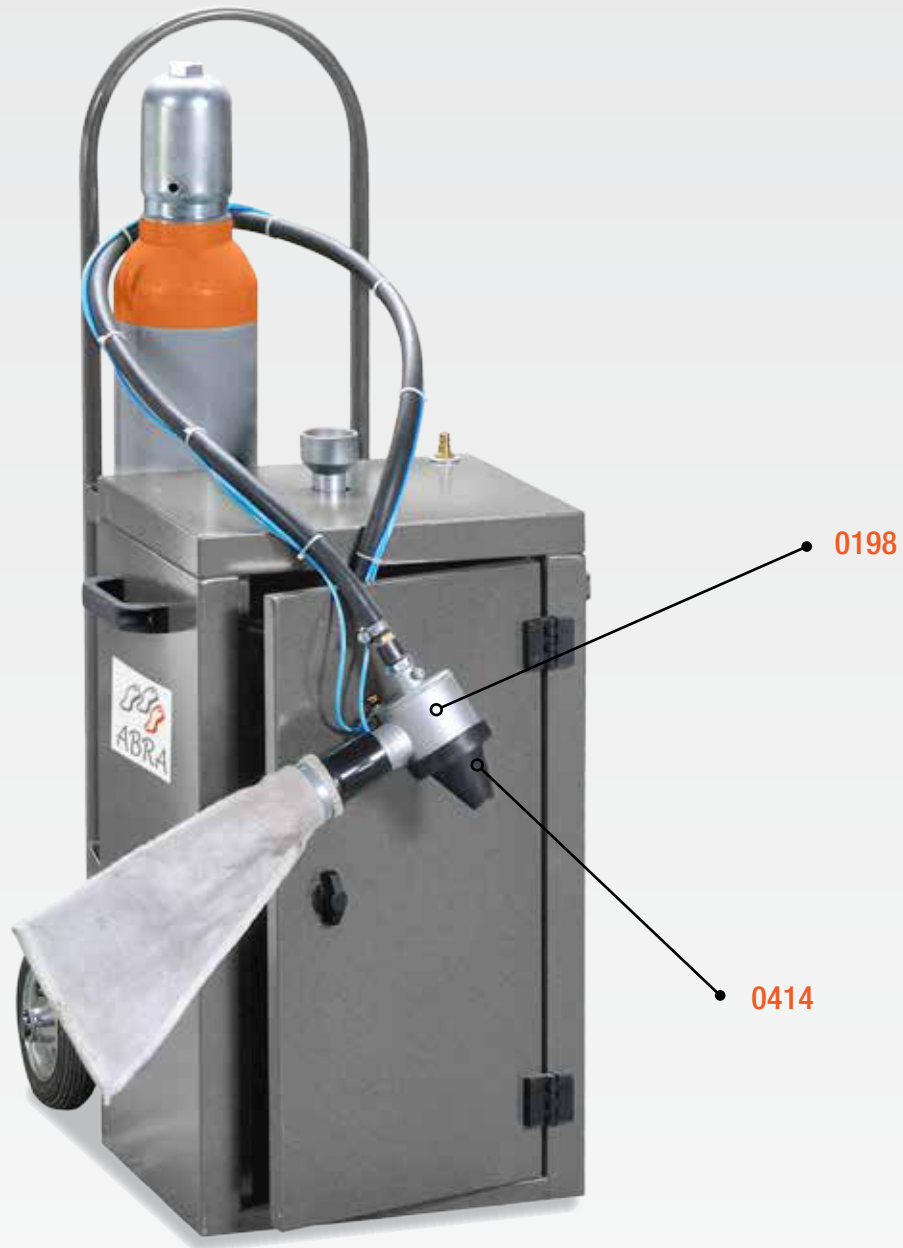

**Complete head**

0198



Complete sandblasting head for Sandmaster Mobile.

**Rubber cover of the head**

0414



Rubber cover of the head for Sandmaster Mobile sandblasting machine, it is put on the cup.



# Accessories Nozzles

**Abrasive nozzle – sintered carbide  
3mm**

5109



Abrasive nozzle – sintered carbide, internal diameter 3mm.

**Abrasive nozzle – sintered carbide  
4mm**

5110



Abrasive nozzle – sintered carbide, internal diameter 4mm.

**Abrasive nozzle – boron carbide  
4mm Plus/Pro**

5113



Abrasive nozzle – boron carbide 4mm.

**Abrasive nozzle – boron carbide  
5mm Plus/Pro**

5114



Abrasive nozzle – boron carbide 5mm.

**Abrasive nozzle – boron carbide  
6mm Plus/Pro**

5115



Abrasive nozzle – boron carbide 6mm.

**Venturi nozzle, UBC borcarbide  
6,5 mm**

4022



Borcarbide nozzle for CL-type cleaners (internal diameter: 6,5 mm).

**Venturi nozzle, UBC borcarbide  
8 mm**

4023



Borcarbide nozzle for CL-type cleaners (internal diameter: 8,0 mm).

**Venturi nozzle, UBC borcarbide  
9,5 mm**

4024



Borcarbide nozzle for CL-type cleaners (internal diameter: 9,5 mm).

**Venturi nozzle, UBC borcarbide  
11 mm**

4025



Borcarbide nozzle for CL-type cleaners (internal diameter: 11 mm).

**Venturi nozzle, UTC tungsten  
carbide UTC-11 mm**

4029



Tungsten carbide nozzle for CL-type cleaners (internal diameter: 11 mm).

**Venturi nozzle, UTC tungsten  
carbide UTC-6,5 mm**

4026



Tungsten carbide nozzle for CL-type cleaners (internal diameter: 6,5 mm).

**Abrasive nozzle – boron carbide  
3mm**

4044



Abrasive nozzle – boron carbide, internal diameter 3mm.

**Abrasive nozzle – boron carbide  
4mm**

4045



Abrasive nozzle – boron carbide, internal diameter 4mm .

**Abrasive nozzle – boron carbide  
5mm**

4046



Abrasive nozzle – boron carbide, internal diameter 5mm .

**Venturi nozzle,  
UTC tungsten carbide 8 mm**

4027



Tungsten carbide nozzle for CL-type cleaners (internal diameter: 8 mm)

**Venturi nozzle,  
UTC tungsten carbide 9,5 mm**

4028



Tungsten carbide nozzle for CL-type cleaners (internal diameter: 9,5 mm)

**Dysza ścierniwa węglík boru  
Eco Plus**

5621

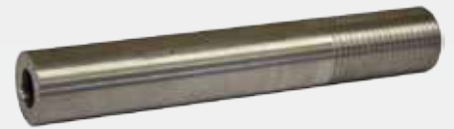

Dysza ścierniwa z węglík boru o średnicy 5 mm. Znajduje się w głowicy piaskującej.

## Accessories Abrasives

**36' silicon carbide**

0084



36' silicon carbide for injector sandblasting machines. Bag: 25 kg.

**40' brown fused alumina**

0035



40' brown fused alumina, for sandblasting in stone or for blasting metal structures. Bag: 25 kg.

**180' white fused alumina**

5296



180' white fused alumina, for sandblasting in phototechnology. Bag: 25 kg.

**100' brown fused alumina**

5294



100' brown fused alumina, for sandblasting in glass. Bag: 25 kg.

# Accessories Brushes

**One-row brush  
Eco Plus**

0178



One-row brush with short, black hairs for Eco-Plus.

**Two-row brush - short hair**

5127



Two-row brush - short hair.

**Three-row brush - short hair**

5128



Three-row brush - short hair.

**Three-row brush - long hair  
Sandmaster**

2031



Three-row brush - long hair.

**Three-row brush  
Eco Plus**

2032



Three-row brush with long, white hairs for Eco-Plus.

# Accessories for plotters

**Standard  
Summa knife**

5274



Standard knife for Summa plotters.

**Reinforced  
Summa Sandblast knife**

5273



Reinforced knife for Summa plotters.

**Roland knife, ZECU-1715  
green end**

5269



Knife dedicated to Roland plotters.

**Standard knife holder  
for Summa plotters**

5282



Standard knife holder dedicated to Summa plotters.

**Reinforced knife holder (bras)  
for Summa plotters**

5281



Reinforced knife holder dedicated to Summa plotters.

**Pen  
for Summa plotters**

5275



Pen dedicated to Summa plotters.

**Pen  
for Roland plotters**

5276



Pen dedicated to Roland plotters.

**Knife  
for cutting foil**

0232



Knife for cutting foil.

**Accessories  
Cliparts**

**Tomb images album  
(catalogue)**

5051



This album includes images for phototechnology.

**Tomb images album  
(CD1)**

5052



This CD includes images for phototechnology.

**Tomb images album  
(CD2)**

5053



This CD includes images for phototechnology.

**Catalogue of tomb cliparts  
part 1 (CD)**

5054



The collection of 100 tomb cliparts in cdr and eps formats (Angel, Jesus, Mary, crosses and other images).

**Catalogue of tomb cliparts  
part 2 (CD)**

5055



The collection of 150 tomb cliparts in cdr and eps formats (crosses).

**Catalogue of tomb cliparts  
part 3 (CD)**

5056

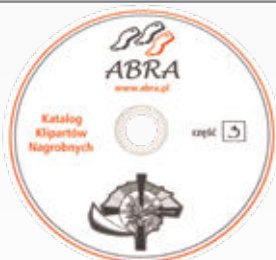

The collection of 125 tomb cliparts in cdr and eps formats (Angel, Jesus, Mary, crosses and other images).

**Catalogue of tomb cliparts  
part 4 (CD)**

5057



The collection of 144 tomb cliparts in cdr and eps formats (Angel, Jesus, Mary, crosses and other images).

**Catalogue of tomb cliparts  
part 5 (CD)**

5058



The collection of 150 tomb cliparts in cdr and eps formats (Angel, Jesus, Mary, crosses and other images).

**Catalogue of tomb cliparts  
part 6 (CD)**

5059



The collection of 125 tomb cliparts in cdr and eps formats (Angel, Jesus, Mary, crosses and other images).

**Templates and ornaments for  
sandblasting part 1 CD**

5062



The collection of templates and ornaments for sandblasting on glass with the use of phototechnology.

**Templates and ornaments for  
sandblasting part 2 CD**

5063



The collection of templates and ornaments for sandblasting on glass with the use of phototechnology.

**Catalogue of tomb cliparts  
and catalogue of templates**

5060



Calogue of tomb cliparts and catalogue of templates and ornaments for sandblasting

**Accessories  
Saws**

**Silent saw, 300 mm diameter,  
40x3.2x10 mm**

5214



Silent saw (diameter: 300 mm), for wet cutting, diamond sawblade - 10 mm.

**Silent saw, 400 mm diameter,  
40x3.6x15 mm**

5215



Silent saw (diameter: 400 mm), for wet cutting, diamond sawblade - 10 mm.

**Silent saw, 500 mm diameter,  
40x4.0x15 mm**

5216



Silent saw (diameter: 500 mm), for wet cutting, diamond sawblade - 10 mm.

**Silent saw, 600 mm diameter,  
40x4.6x15 mm**

5217



Silent saw (diameter: 600 mm), for wet cutting, diamond sawblade - 10 mm.

**Diamond saw  
230 mm**

5447



Diamond saw (diameter: 230 mm) for dry cutting, diamond sawblade - 7 mm.

**Silent diamond saw,  
400 mm diameter, Abra**

5446



Diamond saw (diameter: 400 mm) for wet cutting, diamond sawblade - 20 mm.

**Silent diamond saw,  
500 mm diameter, Abra**

7027



Diamond saw (diameter: 500 mm) for wet cutting, diamond sawblade - 20 mm

**Silent diamond saw,  
600 mm diameter, Abra**

7028



Diamond saw (diameter: 600 mm) for wet cutting, diamond sawblade - 20 mm

## Accessories Polishing pads

**Rubber holder (fastening)  
for polishing pads**

5243



Flexible holder for polishing pads.

**Plastic holder (fastening)  
for polishing pads**

5244



Rigid holder for rubber polishing pads.

**Foam holder (fastening)  
for polishing pads**

5245



Foam holder for rubber polishing pads.

**Polishing pad, granulation:50,  
diameter:100 for wet polishing**

5251



Polishing pad, granulation: 50, for wet polishing.

**Polishing pad, granulation:100,  
diameter:100 for wet polishing**

5246



Polishing pad, granulation: 100, for wet polishing.

**Polishing pad, granulation:200,  
diameter:100 for wet polishing**

5248



Polishing pad, granulation: 200, for wet polishing.

**Polishing pad, granulation:400,  
diameter:100 for wet polishing**

5250



Polishing pad, granulation: 400, for wet polishing.

**Polishing pad, granulation:800,  
diameter:100 for wet polishing**

5252



Polishing pad, granulation: 800, for wet polishing.

**Polishing pad, granulation:1500,  
diameter:100 for wet polishing**

5247



Polishing pad, granulation: 1500, for wet polishing.

**Polishing pad, granulation:3000,  
diameter:100 for wet polishing**

5249



Polishing pad, granulation: 3000, for wet polishing.

**Polishing pad  
BUFF**

5255



Polishing pad BUFF for wet polishing.

## Accessories Polishing materials and strippers

**Polishing element, stripper,  
column grinder 50**

2101



Polishing element, stripper, column grinder 50.

**Polishing element, stripper,  
column grinder 200**

2102



Polishing element, stripper, column grinder 200.

**Polishing element, stripper,  
column grinder 400**

2103



Polishing element, stripper, column grinder 400.

**Polishing element,  
column grinder 500**

2105



Polishing element, column grinder 500.

**Polishing element,  
column grinder 800**

2106



Polishing element, column grinder 800.

**Polishing element,  
column grinder 1500**

2107



Polishing element, column grinder 1500.

**Final polishing element A,  
column grinder**

2108



Final polishing element A, column grinder.

**Final polishing element B,  
column grinder**

2109



Final polishing element B, column grinder.

# Accessories for machines

## Engraving plotters

### Diamond stylus

2113



Diamond stylus.

# Accessories for machines

## Cutting machine D2000

### Support roller (D2000 and D3200)

1040



Support roller (D2000 and D3200).

### Laser pointer (red)

5431



Laser pointer (red).

### Water pump (D2000)

0469



Water pump (D2000).

### Laser pointer (green)

5431



Laser pointer (green).

# Accessories for machines

## Crushers

### Crusher's inductive sensor

0418



Crusher's inductive sensor.

### Crushing knife (upper)

5074



Crushing knife (upper).



# Accessories for machines

## Cutting machine D3200

Support roller  
(D2000 and D3200)

1040



Support roller (D2000 and D3200).

Laser pointer  
(green)

5431



Laser pointer (green).

Rotating roller  
(D2000 and D3200)

0568



Rotating roller (D2000 and D3200).

Laser pointer  
(red)

5431



Laser pointer (red).

Crusher jaws

0226

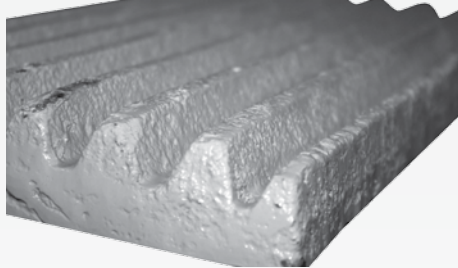

Crusher jaws.

# Accessories for machines

## Crushers

# Accessories

## Sandblastfilms

### Hard 0,25 sandblast film

5402

Because of its thickness it is used mainly for sandblasting glass or for delicate and shallow sandblasting in stone as a covering foil.



### Hard 0,4 sandblast film

5023

This is the most popular film for sandblasting in stone. Its characteristic feature is plasticity which ensures high comfort and work efficiency. It does not require using special knives in plotters. This product has excellent durability parameters which allow for deep sandblasting. It also has an excellent adhesive layer.



### Hard 0,45 sandblast film

5036

Sandblast film for sandblasting in stone recommended for demanding users who want to sandblast quickly and deeply. It has an excellent adhesive layer and has high resistance to low temperatures.



### Hard 0,55 sandblast film

7030

0,55 mm thick film for extremely deep sandblasting. Very attractive high quality product, has very good durability parameters, much better than other types of films.



# Head scheme

## Eco Plus

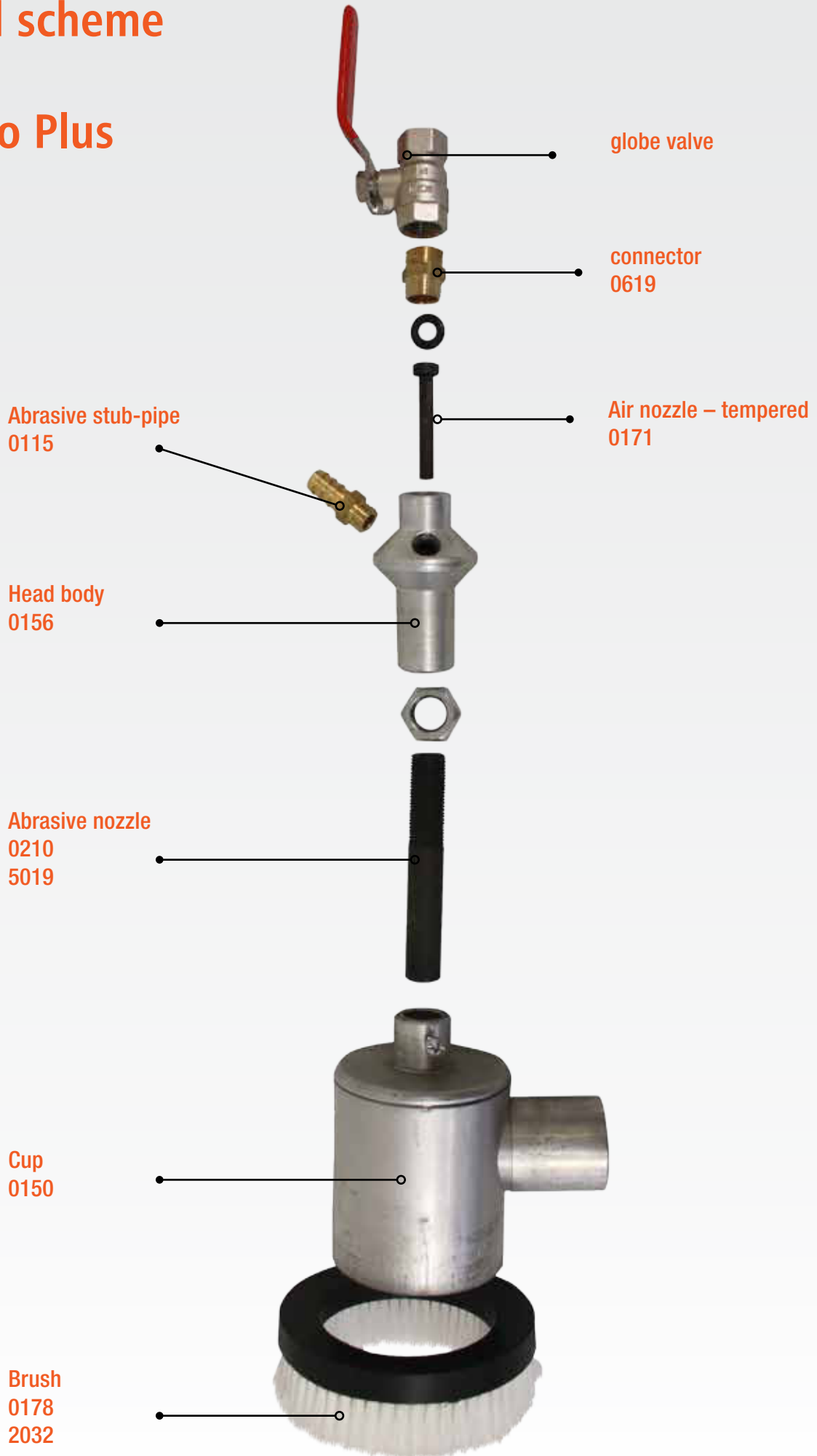

# Head scheme

## Junior Junior Plus

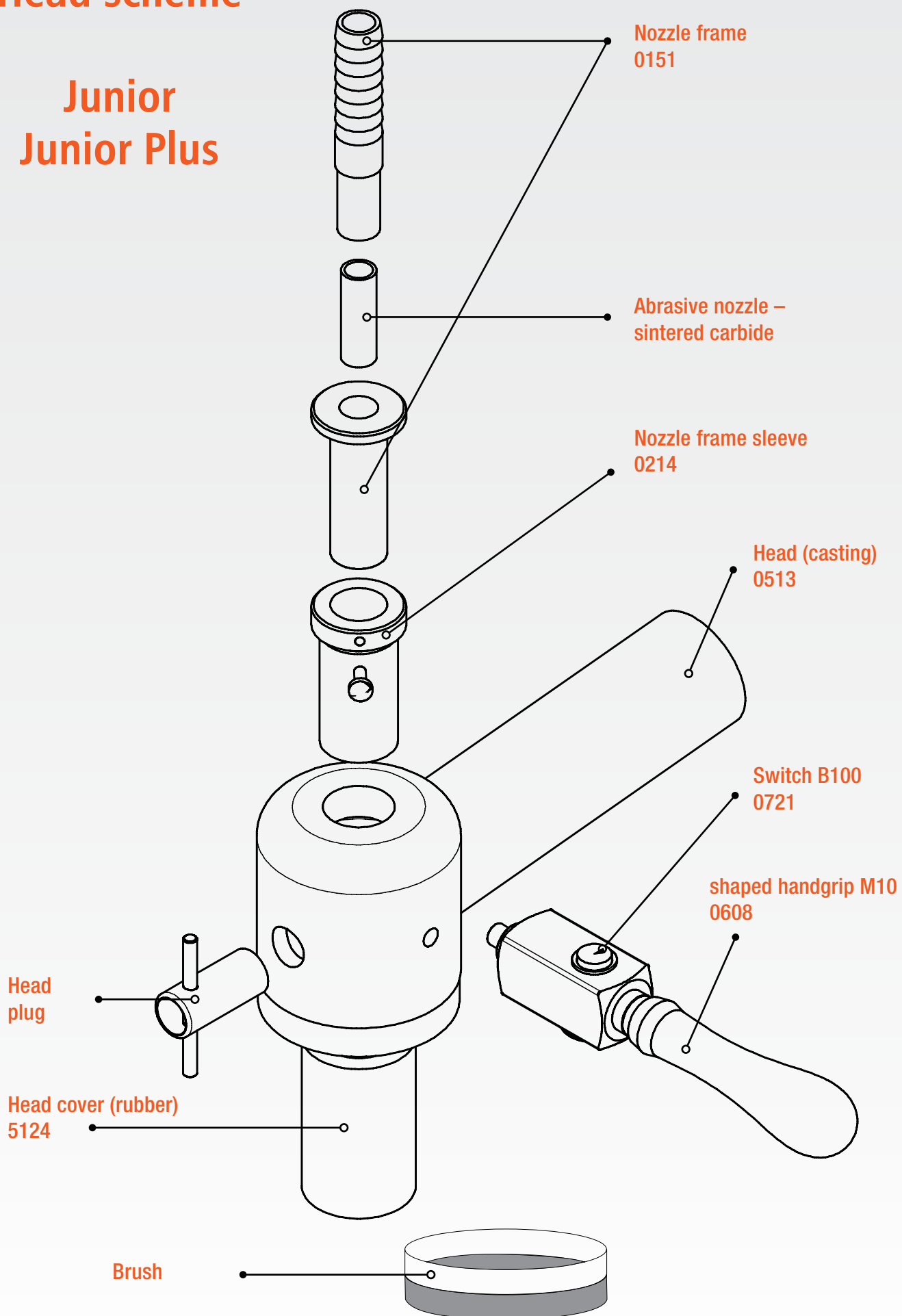

# Head scheme

**Plus  
Pro**

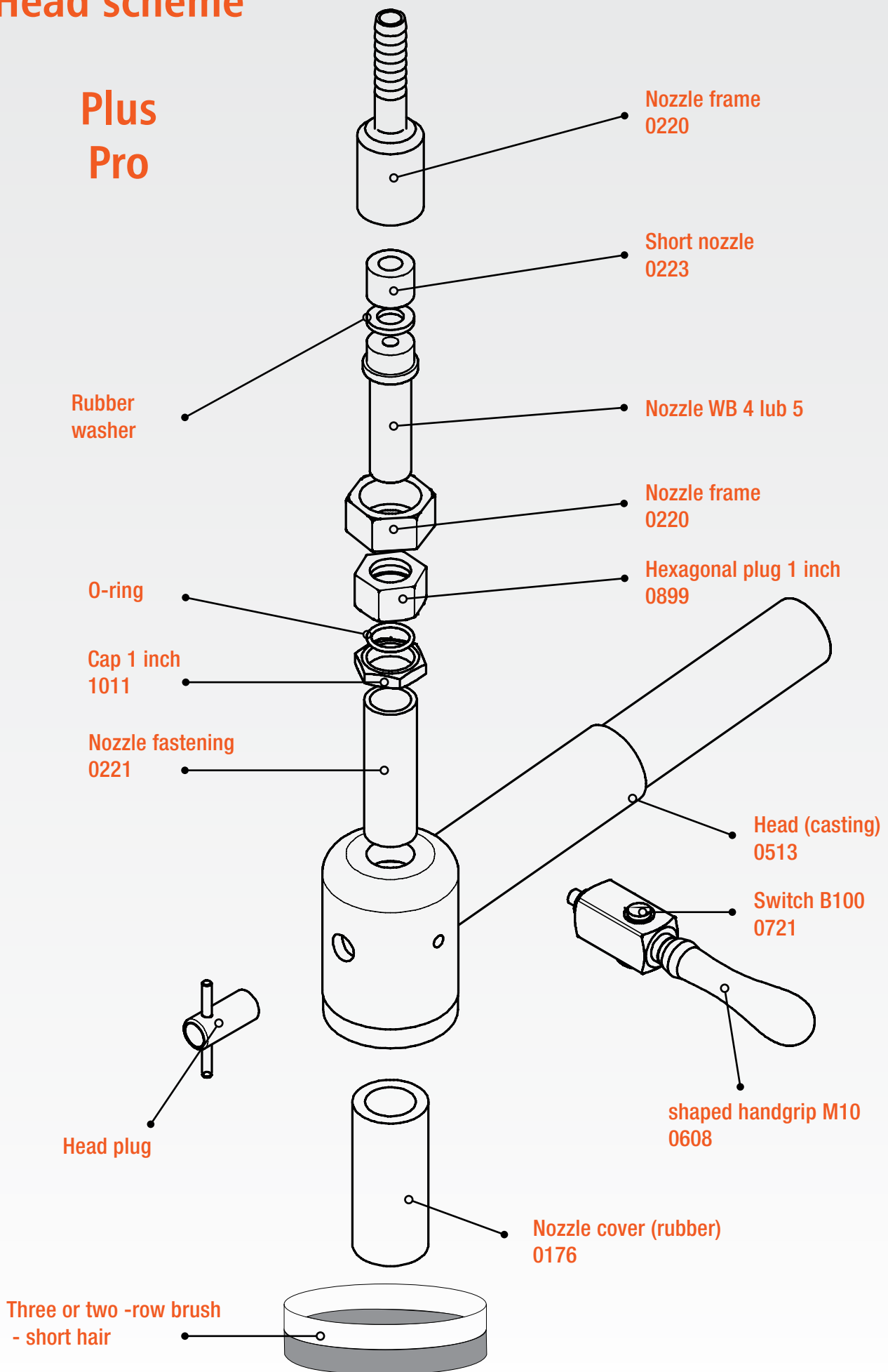

# Head scheme

## Automatic tables

